



TORQUE MOTORS

AEP PART NUMBER	STALL TORQUE (OZ-IN)*	N.L. RPM	V	Hz	Ph	FRAME SIZE	LENGTH		AEP PART NUMBER	STALL TORQUE (OZ-IN)*	N.L. RPM	V	Hz	Ph	FRAME SIZE	LENGTH	
							In	mm								In	mm
41DKM-1	2.5	1705	115	60	1	18	2.50	64	64NKP-10A	45.0	1710	115	60	1	34	4.00	102
407EXM-1	3.0	3410	115	60	2	18	2.00	51	72QKP-1	55.0	1735	115	60	1	34	3.88	99
40MXM-1	3.5	23750	208	400	3	18	2.75	70	112LMM-1	60.0	875	75	60	1	44	4.07	103
44GKM-1C	4.5	1630	115	60	1	18	3.25	83	74QKP-1	65.0	1745	115	60	1	34	4.00	102
52MZU-1	8.0	5700	208	400	3	18	3.00	76	122NLP-1	65.0	1140	115	60	1	44	4.05	103
74KZP-1	8.0	5750	115	400	3	34	4.38	111	78PKP-4E	75.0	1645	115	60	1	34	5.25	133
60KKP-1	15.0	1725	115	60	1	34	3.95	100	88MMP-1	80.0	855	115	60	1	39	5.81	148
86KZU-1A	20.0	4000	115	400	1	39	5.45	138	114MMP-1	80.0	855	240	60	1	44	5.84	148
120KMP-1	25.0	1720	115	60	1	44	3.03	77	74NKP-13	85.0	1730	115	60	1	34	4.38	111
64LLP-1	28.0	1180	115	60	1	34	4.25	108	112NLP-2	90.0	1185	115	60	1	44	4.25	108
74NKP-1	30.0	1700	115	60	1	34	4.13	105	74NKP-10K	100.0	1100	115	60	1	34	4.000	102
90MZU-1	30.0	2980	20	400	2	46	4.00	102	78NLP-1A	100.0	1160	115	60	1	39	5.25	133
82PKU-1	30.0	1770	115	60	1	39	4.45	113	1112KLP-1	135.0	945	115	60	1	44	5.57	142
60LLP-1	30.0	1160	115	60	1	34	3.25	83	1112KMP-1	155.0	875	115	60	1	44	6.57	167
74MMP-1	35.0	855	95	60	1	34	4.25	108	118KMU-3	165.0	880	115	60	1	44	5.83	148
74NKP-16	35.0	1700	115	60	1	34	4.00	102	96RMP-1	225.0	810	115	60	1	46	5.25	133
122NKP-2C	40.0	1440	115	60	1	44	3.82	97	96UKP-2	250.0	1710	115	60	1	46	5.25	133
74NKP-10E	45.0	1760	115	60	1	34	4.00	102	96SLP-7	290.0	1165	115	60	1	46	5.25	133
122NKP-1	45.0	1690	115	60	1	44	3.88	99	98TTL-1	420.0	1080	115	60	1	46	6.25	160

*GR-CM = OZ-IN x 72

Features vary with applications and customer requirements and include:

- Single, multi or variable speed
- Totally enclosed, open, ventilated, non-ventilated
- Single and double shaft extensions
- Flats, keyways or threaded extensions
- Metric or inch shaft extensions and mountings
- Lead configurations, connectors, junction boxes
- Special connection diagrams





TORQUE MOTORS

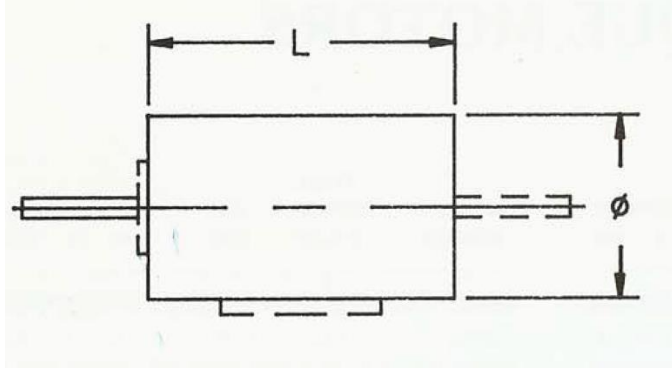

FRAME SIZE	DIAMETER	
	In	mm
18	1.75	45
20	2.00	50
31	3.12	80
34	3.31	84
39	3.88	98
44	4.38	111
46	4.62	117
54	5.38	137
56	5.50	140
184	8.50	216

STANDARD CONNECTION DIAGRAMS

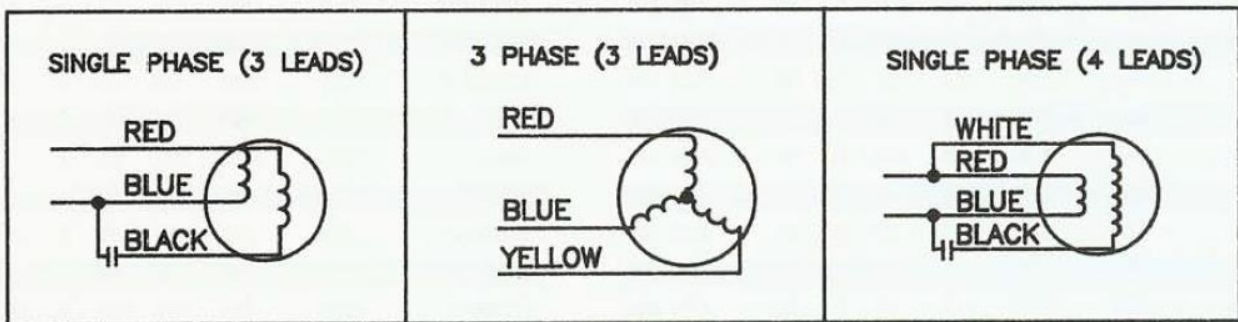

Other ASHLAND Products Include:

- Centrifugal Blowers
- Radial Blade Blowers
- Multi Stage Blowers
- Crossflow Blowers
- Tangential Blowers
- Tubeaxial Fans
- Propeller Fans
- Axial Fans
- Torque Motors
- Induction Motors
- DC to AC inverters
- Stator & Rotor Sets
- Synchronous Motors
- Contract Machining

For information on these products or assistance with your specific application, contact the factory or your ASHLAND representative.

-- Ashland Electric Products, Inc. is a Small Veteran Owned Company --