



# SYNCHRONOUS MOTORS

AEP PART NUMBER	TORQUE PULL IN (OZ-IN)*	RPM	V	Hz	Ph	FRAME SIZE	LENGTH In	mm	**	AEP PART NUMBER	TORQUE PULL IN (OZ-IN)*	RPM	V	Hz	Ph	FRAME SIZE	LENGTH In	mm	**
42DAM-4	0.5	3600	115	60	1	18	2.68	68	H	80MFU-5	15.0	1800	115	60	1	39	3.95	100	R
54DAAZU-1	0.5	3600	115	60	1	20	3.50	89	H	112KZU-1	16.0	600	115	60	2	44	4.75	121	H
42ACM-1	1.0	1000	115	50	1	18	2.25	57	H	92HZU-1A	17.0	450	115	60	1	46	4.50	114	H
52HDU-1	1.0	1800	60	120	2	20	3.00	76	R	64RAU-1	18.0	3600	115	60	1	34	4.63	118	H
50GAU-1	1.5	3600	115	60	1	20	2.50	64	H	72HHU-1	19.0	900	115	50	1	34	4.06	103	R
42AEM-7C	1.5	5100	14	85	2	18	2.68	68	R	86MBU-1	20.0	1800	100	60	2	39	5.50	140	H
52LCR-1	2.0	8000	115	400	1	20	3.00	76	H	116RANBU-3	20.0	1800/3600	230	60	1	44	5.44	138	H
42DFM-7	2.0	1800	12	60	1	18	2.72	69	R	86NCU-1	25.0	1200	115	60	1	39	5.45	138	H
42HAM-1	2.5	3600	115	60	1	18	2.72	69	H	62QFU-2	25.0	1800	115	60	1	34	4.00	102	R
52HAU-2A	2.5	3600	115	60	1	20	3.00	76	H	118XBU-2	25.0	15000	100	500	3	44	6.00	152	H
54NDK-2	2.8	8000	208	400	3	20	3.50	89	H	76QBU-1	25.0	1800	115	60	1	34	5.16	131	H
52MDK-1	3.0	8000	208	400	3	20	3.00	76	H	98GZKZU-3Z	28.0	250/500	230	50	1	46	6.00	152	H
607EHU-1	3.0	800	115	60	1	34	3.25	83	R	66QBU-1Z	30.0	1500	230	50	1	34	5.13	130	H
42KAM-2	3.5	3600	115	60	1	18	2.68	68	H	116UAU-3Z	30.0	3000	230	50	1	44	5.44	138	H
42SAP-1	4.0	14400	115	240	3	18	2.94	75	H	78TAU-1	30.0	3600	115	60	1	34	5.63	143	H
60KBU-1	5.0	1800	115	60	1	34	3.50	90	H	88RBU-1	30.0	1800	208	60	1	39	5.95	151	H
84DZU-1	5.0	600	115	60	1	39	4.95	126	H	88PCU-2Z	34.0	1000	230	50	1	39	6.11	155	H
42PWM-1	5.0	3600	57	120	3	18	2.94	75	H	118TAU-1	36.0	3600	115	60	1	44	6.00	152	H
73DCU-1	5.0	800	60	40	2	34	4.13	105	H	88SBU-2BZ	41.0	1500	115	50	1	39	5.95	151	H
44SXP-5	6.3	12000	115	400	1	18	3.18	81	H	118VAU-2	43.0	3600	115	60	1	44	5.75	146	H
63FDKBU-1	8.0	1800/900	115	60	1	34	4.38	111	H	88SFU-1	45.0	1800	115	60	1	39	5.87	149	R
84HCEZU-23K	10.0	1200	115	60	1	39	4.83	123	H	98WAUBU-1	75.0	1800/3600	115	60	1	46	6.00	152	H
74HBP-1	10.0	1800	115	60	1	34	3.50	89	H	98YAU-1C	98.0	3600	115	60	1	46	6.31	160	H
76MBU-1	15.0	1800	115	60	1	34	5.19	132	H	912ZAU-3A	105.0	3600	208	60	3	46	7.31	186	H
62NBU-1	15.0	1800	115	60	1	34	4.00	102	H	912ZAU-1A	120.0	3600	115	60	1	46	7.31	186	H

\* GR-CM = OZ-IN x 72

\*\* H = HYSTERESIS

R = RELUCTANCE

Features vary with applications and customer requirements and include:

- Single, multi or variable speed
- Totally enclosed, open, ventilated, non-ventilated
- Single and double shaft extensions
- Flats, keyways or threaded extensions
- Metric or inch shaft extensions and mountings
- Lead configurations, connectors, junction boxes
- Special connection diagrams





# SYNCHRONOUS MOTORS

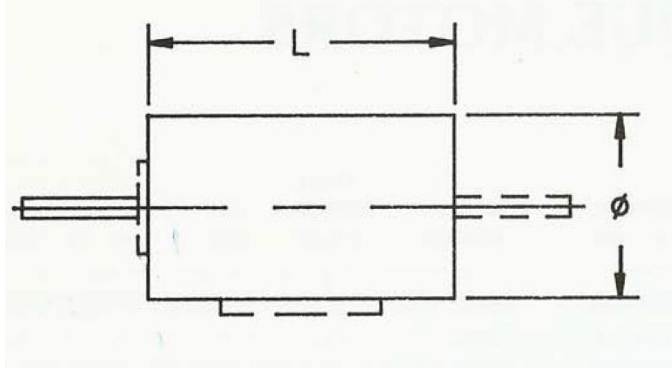

FRAME SIZE	DIAMETER	
	In	mm
18	1.75	45
20	2.00	50
31	3.12	80
34	3.31	84
39	3.88	98
44	4.38	111
46	4.62	117
54	5.38	137
56	5.50	140
184	8.50	216

## STANDARD CONNECTION DIAGRAMS

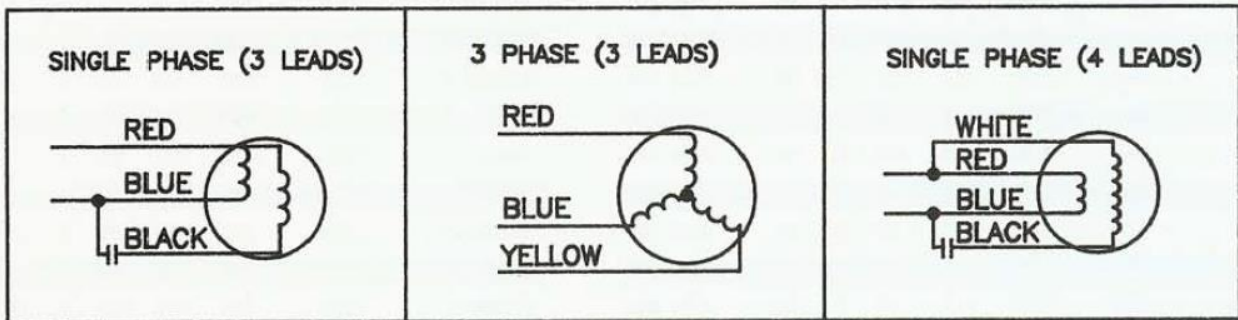

### Other **ASHLAND** Products Include:

- Centrifugal Blowers
- Radial Blade Blowers
- Multi Stage Blowers
- Crossflow Blowers
- Tangential Blowers
- Tubeaxial Fans
- Propeller Fans
- Axial Fans
- Torque Motors
- Induction Motors
- DC to AC inverters
- Stator & Rotor Sets
- Synchronous Motors
- Contract Machining

For information on these products or assistance with your specific application, contact the factory or your **ASHLAND** representative.

**-- Ashland Electric Products, Inc. is a Small Veteran Owned Company --**