



INDUCTION MOTORS

AEP PART NUMBER	TORQUE (OZ-IN)*	RPM	V	Hz	Ph	FRAME SIZE	LENGTH In	mm
405HXM-1	0.3	23250	18	400	3	18	1.75	45
405CJM-1	0.5	3435	115	60	1	18	1.75	45
50EJU-1	0.8	3450	115	60	1	20	2.56	65
307CKM-3	1.0	1365	115	60	1	18	1.75	45
40MJM-1	1.0	22550	115	400	1	18	2.31	59
42EJK-2	1.0	3350	115	60	1	18	2.69	68
50MJR-1A	1.0	20100	115	400	1	20	2.63	67
42GJM-1	1.5	3400	115	60	1	18	2.69	68
407AWM-1	2.0	1310	150	60	1	18	2.25	57
52KZU-1	2.0	3600	208	400	3	20	3.00	76
42KZK-1	3.0	3150	115	400	1	18	2.69	68
36KJK-1	3.5	3300	115	60	1	18	3.69	94
50GJM-1	3.5	3040	115	60	1	20	2.31	59
52SKU-1	5.0	11250	115	400	1	20	3.00	76
618MJP-1	5.0	3590	115	60	1	44	6.75	172
70KKM-2	6.0	1700	115	60	1	34	3.13	79
52NZU-2	6.5	5100	115	400	1	20	3.18	81
42LJK-2	6.5	2900	115	60	1	18	2.69	68
42MJR-1	8.0	2990	115	60	1	18	2.69	68
42NJM-2	9.0	2910	115	60	1	8	269	68
60SLP-1	9.0	7650	115	400	1	5	3.25	83
60KKP-3	10.0	1155	115	60	1	34	3.25	83
44SVM-1	12.0	7325	208	400	3	18	3.25	83
74RJP-1	15.0	3300	115	60	1	34	4.38	111
62MKP-1	16.0	1260	115	60	1	34	3.62	92
44VVM-1	20.0	7150	208	400	3	18	3.25	83
46WWTZM	20.0	11000	200	400	3	18	4.00	102
74SXM-1	20.0	3450	208	60	3	34	5.88	149
82SJP-1	20.0	3340	115	60	1	39	4.45	113
121UKU-3	20.0	1740	115	60	1	44	5.00	127
92UZP-1	25.0	4370	115	400	1	46	4.50	114
1112VZU-2	25.0	2960	230	50	1	50	7.95	202
66VJU-1	30.0	3300	115	60	1	60	5.50	140

AEP PART NUMBER	TORQUE (OZ-IN)*	RPM	V	Hz	Ph	FRAME SIZE	LENGTH In	mm
76RKU-1	40	1700	115	60	1	34	5.13	130
110PKP-1	40	1700	115	60	1	44	3.00	76
126XZU-1	40	3290	115	60	1	44	5.50	140
84WJU-1	45	3450	115	60	1	39	4.69	119
76VJM-1	50	3390	115	60	1	34	4.91	125
83SKU-1	60	1535	115	60	1	39	4.31	109
128XJK-1	60	3400	115	30	1	44	6.50	165
76WXK-2	61	23000	208	400	3	34	5.31	135
86TKU-1	64	1480	115	60	1	39	5.45	138
114XJU-1	70	3450	115	60	1	44	4.69	119
74TVP-1	78	1040	208	60	3	34	4.25	108
88WXU-1	80	3418	230	60	3	39	5.95	151
124UKU-1	80	1700	115	60	1	44	5.00	127
98XJM-1	80	3250	230	60	1	46	6.28	160
88ZU-2	90	5600	115	400	1	39	5.95	151
86XXL-1	100	2985	208	60	3	39	5.45	138
124SKU-1	100	1640	115	60	1	44	4.75	121
1112SMP-6	100	550	115	50	1	44	6.98	177
912YJK-1	100	3400	115	60	1	46	8.00	203
116ZVP-1	120	7850	208	400	3	44	5.50	140
118ZJU-1	140	3460	115	60	1	44	5.81	148
98ZZR-1	140	4350	15	400	1	46	6.28	160
1815XKM-1	145	1725	115	60	1	56	8.50	216
118XWM-1	160	1700	208	60	3	44	5.63	143
94ZXR-1	200	3340	115	60	3	46	7.28	185
185XWP-1	200	1725	230	60	3	56	5.00	127
912ZJU-1Z	280	2600	230	50	1	46	7.28	185
536ZU-1	785	3850	200	400	3		8.10	206
536ZU-3	335	1950	208	40	3		4.75	121
629JZZM-1	1150	3850	208	400	3		6.75	171
185ZWM-1	455	1725	200	60	3		4.75	121
212ZZU-1	3025	1900	208	400	3	182	9.88	251

* GR-CM = OZ-IN x 72

Features vary with application and customer requirements and include:

- Single, multi or variable speed
- Totally enclosed, open, ventilated, non-ventilated
- Single and double shaft extensions
- Flats, keyways or threaded extensions
- Metric or inch shaft extensions and mountings
- Lead configurations, connectors, junction boxes
- Special connection diagrams





INDUCTION MOTORS

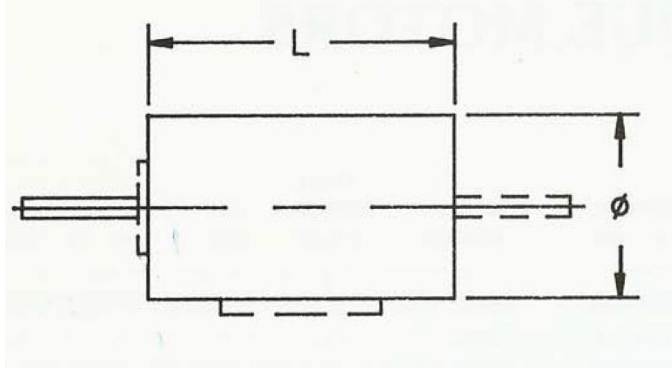

FRAME SIZE	DIAMETER	
	In	mm
18	1.75	45
20	2.00	50
31	3.12	80
34	3.31	84
39	3.88	98
44	4.38	111
46	4.62	117
54	5.38	137
56	5.50	140
184	8.50	216

STANDARD CONNECTION DIAGRAMS

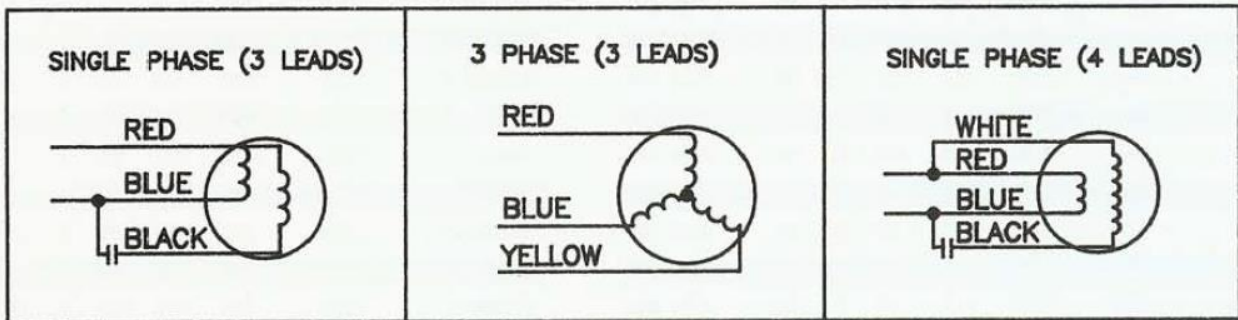

Other **ASHLAND** Products Include:

- Centrifugal Blowers
- Radial Blade Blowers
- Multi Stage Blowers
- Crossflow Blowers
- Tangential Blowers
- Tubeaxial Fans
- Propeller Fans
- Axial Fans
- Torque Motors
- Induction Motors
- DC to AC inverters
- Stator & Rotor Sets
- Synchronous Motors
- Contract Machining

For information on these products or assistance with your specific application, contact the factory or your **ASHLAND** representative.

-- Ashland Electric Products, Inc. is a Small Veteran Owned Company --